

CERTIFICATE OF LOCATION OF GOVERNMENT CORNER

NORTH QUARTER Corner of Section 17, Township 106, Range 39, 5TH P.M.

STATE OF MINNESOTA, County of MURRAY

At the corner location shown on the sketch:

- On _____ found a _____
DATE
- left monument as found, lowered monument, removed monument (explain)
- On 10/14/15 placed a 5/8" iron with seal #50343
DATE

SKETCH OF REFERENCE TIES

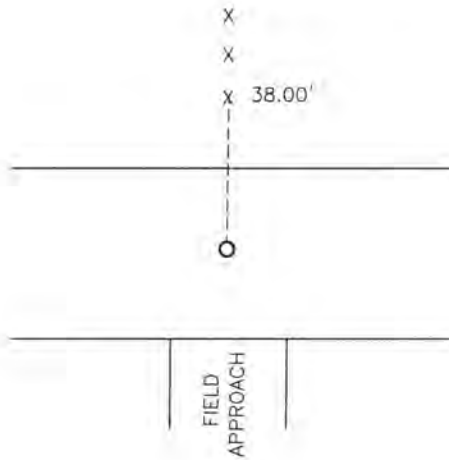

Minnesota State Plane Coordinate
 System Murray County Datum
 NAD83 (1996)
 N: 153054.947
 E: 556196.615

Nail and seal in end post North 38.00'

Statement of evidence relative to this corner location is on back of page.

I hereby certify that this document and the data contained herein was prepared by me or under my direct supervision.

 SIGNATURE
3-21-16
 DATE

Registration No. 50343

- Land Surveyor, Professional Engineer
- County Surveyor, County Engineer

OFFICE OF THE COUNTY RECORDER

County of MURRAY

I hereby certify that this document was filed in the Co. Recorders office at 11:00 A.M on the 18TH day of OCTOBER A.D. 2016

County Recorder Evelyn C. Larson

By _____, Deputy

DOCUMENT NO. _____

Statement of Evidence

In August, 1861, Wellman and Smoot did the original subdivision of the township.

On October 14, 2015, Bueltel-Moseng Land Surveying set a 5/8" iron with seal #50343 on line between section corners and in line with fence to the north.